

OVERHEAD:
UNISTRUT FULL LENGTH OF LAB
P3300
2 FT SPACING

ELECTRIC OUTLET STRIPS
CLEAN & SHIP POWER
2 FT SPACING

WIRE PASS THRU

29 1/2" OPENING
WT

DOUBLE ROW POWER STRIP
UPPER ROW, CLEAN PWR
LOWER ROW, SHIP'S 120V
(TYPICAL)

UNISTRUT
(TYPICAL)
ON 24" C-C

WT

29 1/2" OPENING

SSSG WORK AREA

**Aerosol
Sampler
Controllers**

PRINTER,
DRAWER
UNIT

TERRASCAN
COMPUTER

SEANET
COMPUTER

SSSG PRIMARY USE
COMPUTER
(LINUX or WinNT)

SATELLITE
COMMUN.
RACK

PRINTER in rack

UPTAKE

DATA
SYSTEMS

CNTRL.
STA.

SEABEAM
RACK

68 67 66 65 64

SHIP FRAMES
2 FT/FRAME

DN

CENTER LINE
OF SHIP
IN RELATION
TO LAB

53 52

FWD →

COPY/FAX
MACHINE

24" OPENING

UP TO
BRIDGE

DN TO
01 DK

35 1/2" OPENING

HEAD

WT



SHIP MECHANICAL &
ELECTRICAL INSTALLATIONS,
MUST KEEP CLEAR

**SCIENTIFIC CHART ROOM,
TECHNICIAN'S WORK AREA
R/V Knorr, 02 deck**

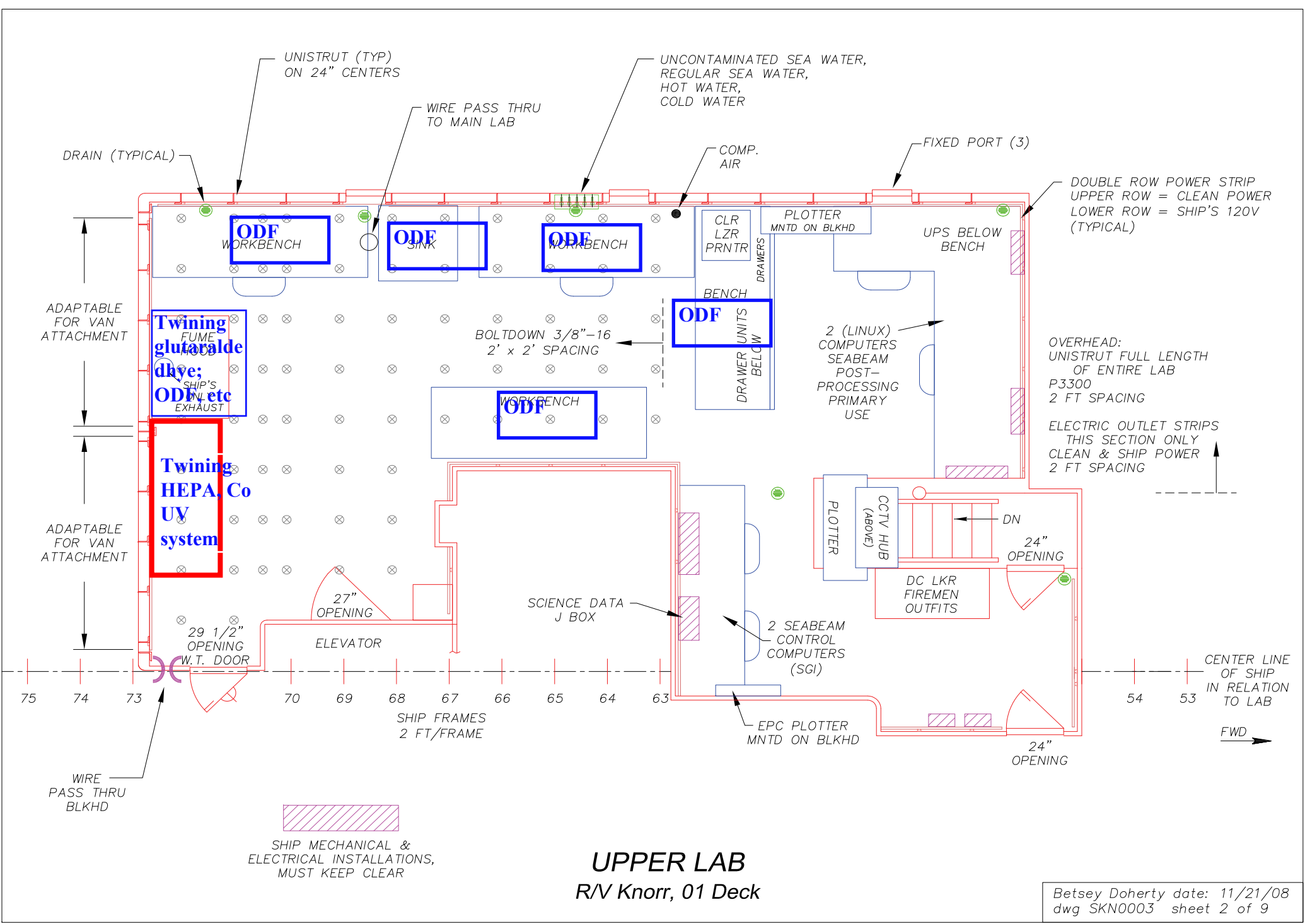

UPPER LAB
R/V Knorr, 01 Deck

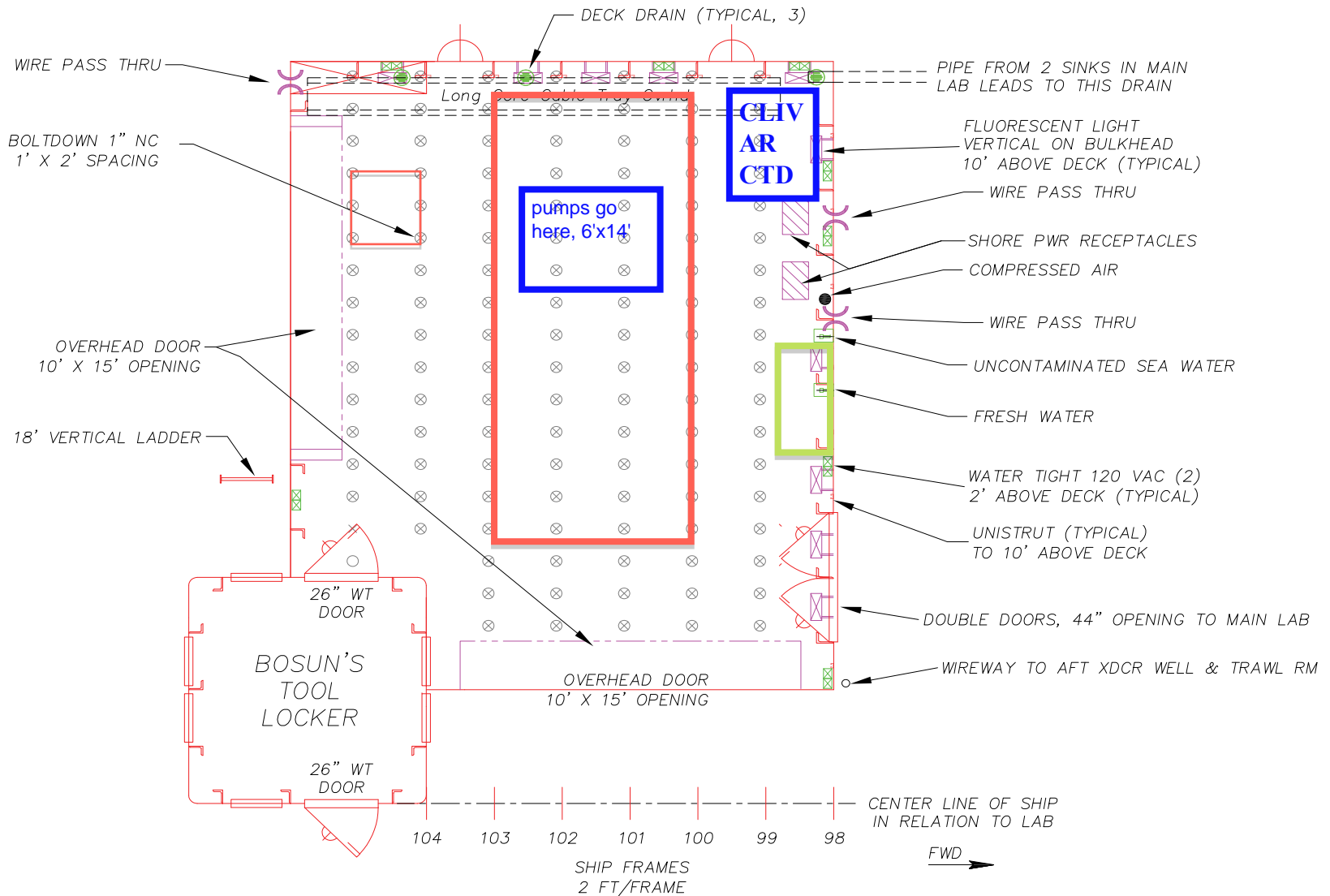

 SHIP MECHANICAL &
 ELECTRICAL INSTALLATIONS,
 MUST KEEP CLEAR

AFT HANGAR
R/V Knorr, main deck

OVERHEAD:
UNISTRUT FULL LENGTH OF LAB (P3300)
2 FT SPACING

ELECTRIC OUTLET STRIPS
CLEAN & SHIP POWER
2 FT SPACING

DOUBLE ROW POWER STRIP
UPPER ROW, CLEAN PWR
LOWER ROW, SHIP'S 120V
4' ABV DECK, 12" PLUG SPACING

UNCONTAMINATED SEA WATER,
REGULAR SEA WATER,
HOT WATER,
COLD WATER
(TYPICAL) 5 PLACES

UNISTRUT
(TYPICAL)
ON 24" CENTERS

COMP. AIR
(TYPICAL)
3 PLACES

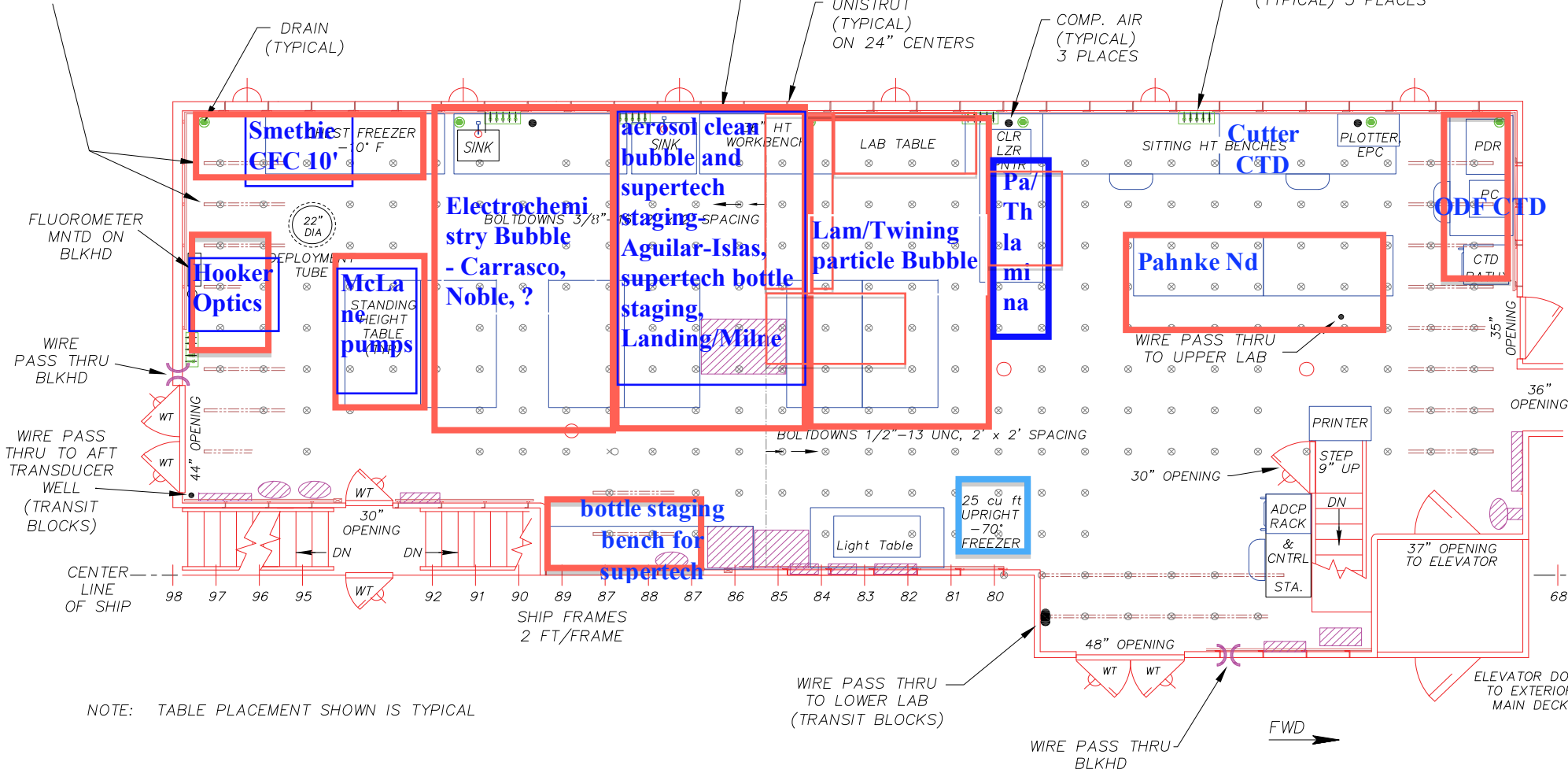

NOTE: TABLE PLACEMENT SHOWN IS TYPICAL

 SHIP MECHANICAL & ELECTRICAL INSTALLATIONS, MUST KEEP CLEAR

MAIN LAB

R/V Knorr, main deck

DOUBLE ROW POWER STRIP
 UPPER ROW, CLEAN PWR
 LOWER ROW, SHIP'S 120V
 4' ABV DECK, 12" PLUG SPACING

MILLI-Q
 DEIONIZED
 WATER SYS.
 MNTD 14"
 OFF BENCH

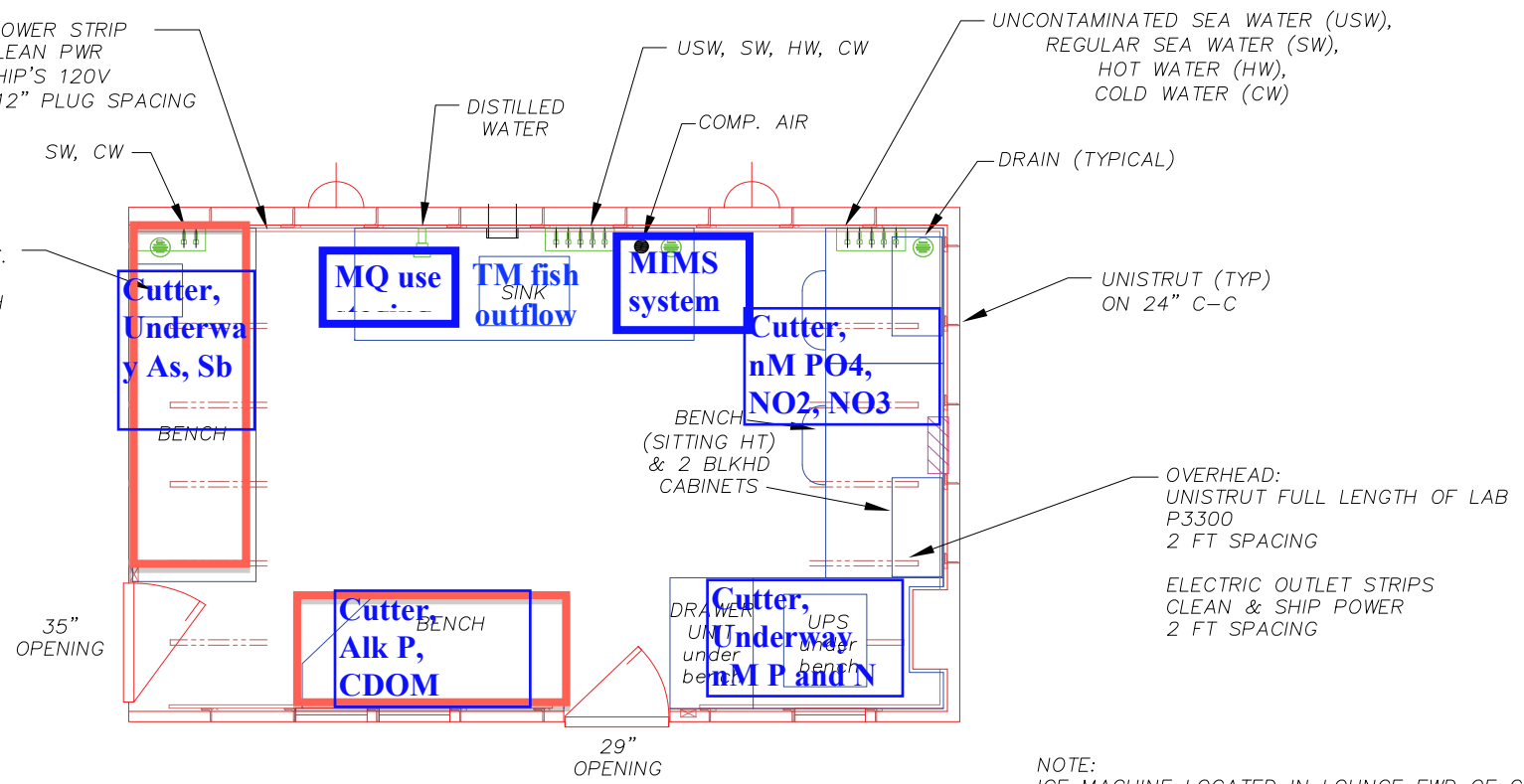

NOTE:
 ICE MACHINE LOCATED IN LOUNGE FWD OF GALLEY →

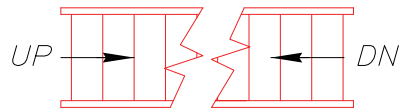

FWD →

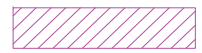
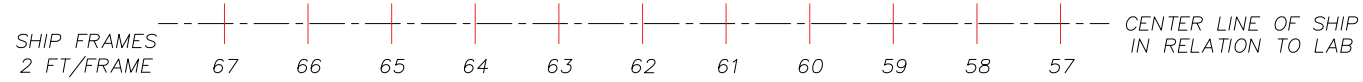

SHIP MECHANICAL &
 ELECTRICAL INSTALLATIONS,
 MUST KEEP CLEAR

ANALYTICAL LAB

R/V Knorr, main deck, fwd of main lab

SHIP FRAMES 2 FT/FRAME 67 66 65 64 63 62 61 60 59 58 57 CENTER LINE OF SHIP IN RELATION TO LAB

FWD →

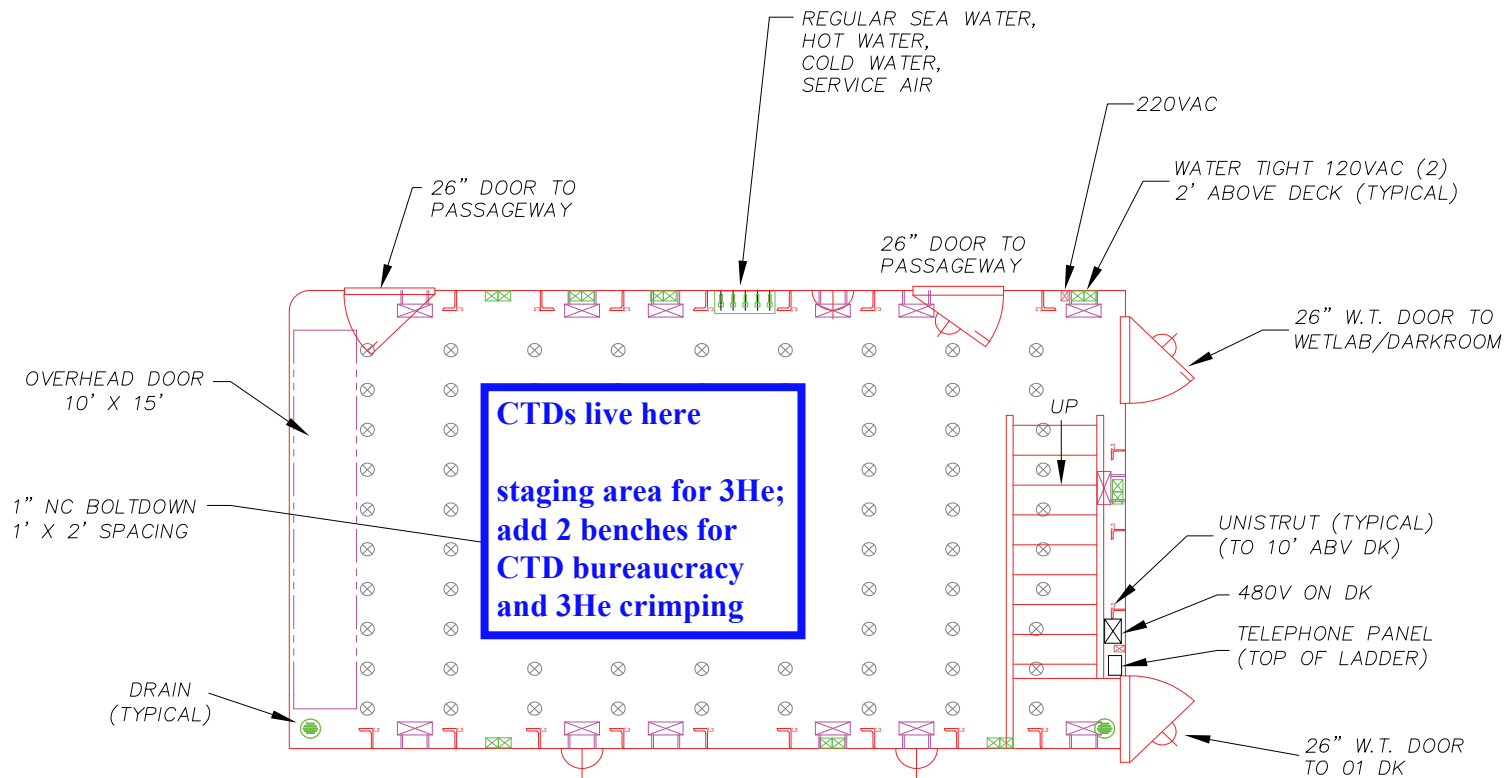

FWD HANGAR
R/V Knorr, main deck

 SHIP MECHANICAL & ELECTRICAL INSTALLATIONS, MUST KEEP CLEAR

SHIP FRAMES 2 FT/FRAME 57 56 55 54 53 52 51 50 49 48 47 46 CENTER LINE OF SHIP IN RELATION TO LAB

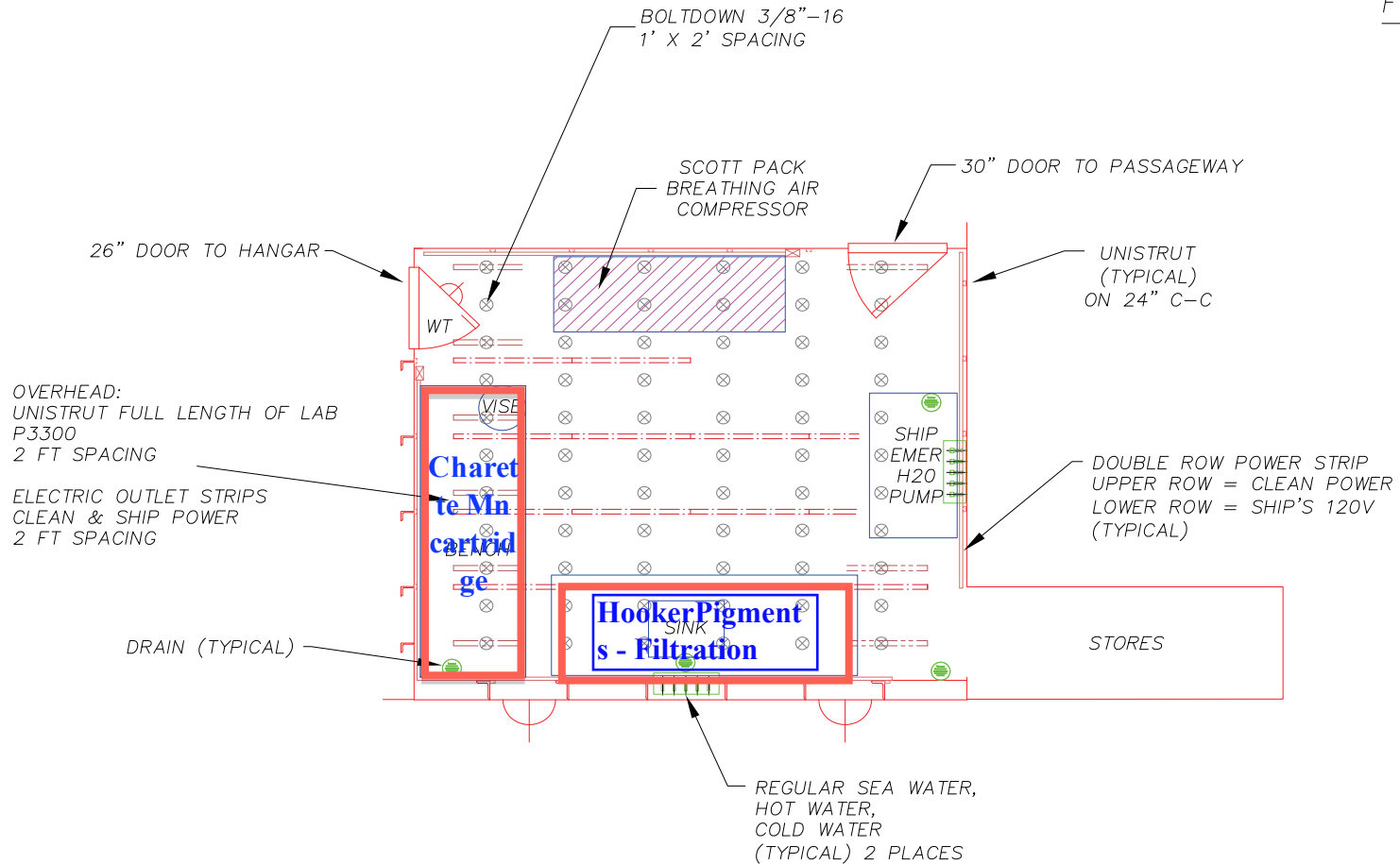

WET LAB / DARKROOM
R/V Knorr, main deck

 SHIP MECHANICAL & ELECTRICAL INSTALLATIONS, MUST KEEP CLEAR

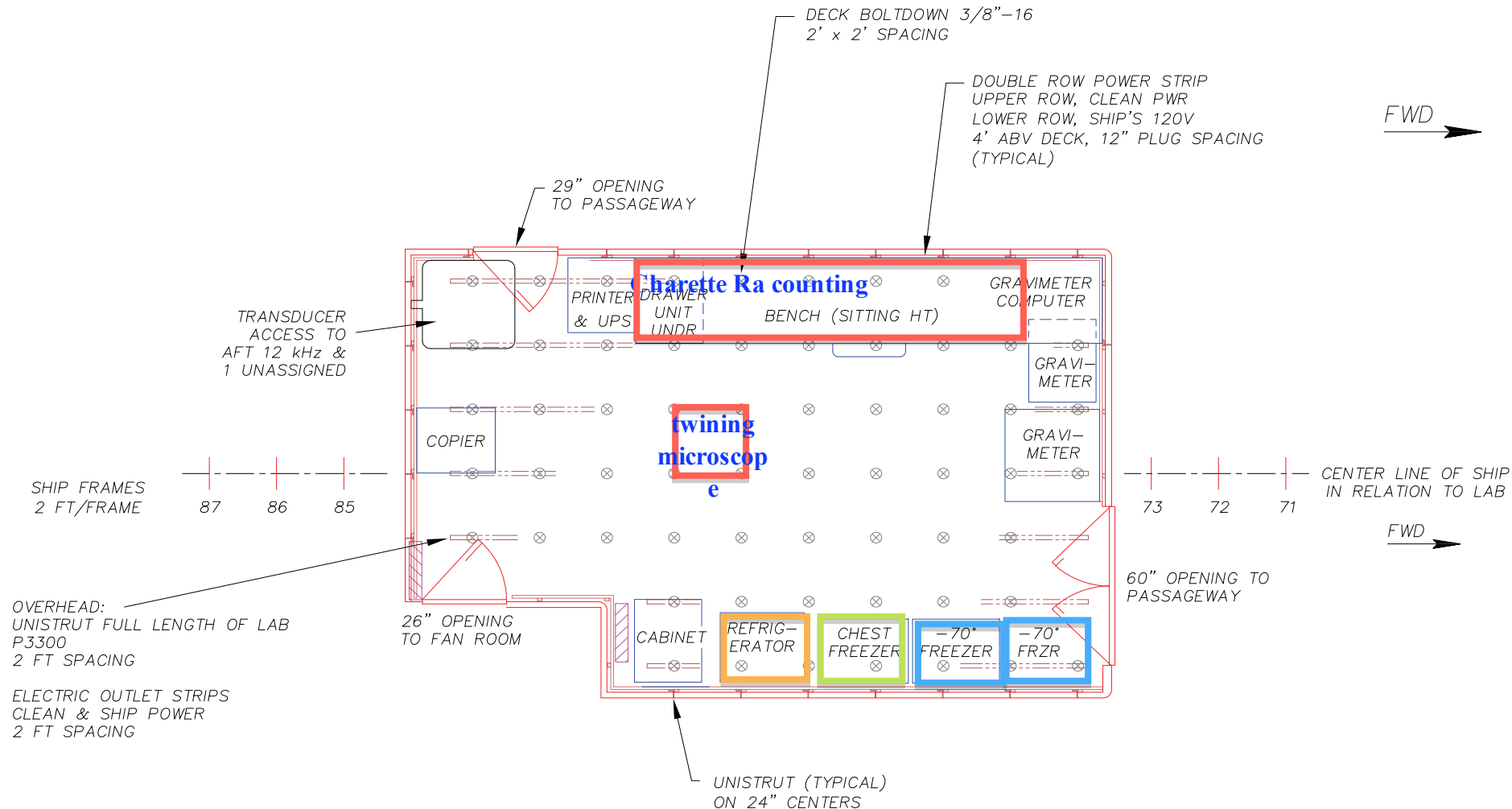

**LOWER LAB,
(DRY LAB)
R/V Knorr, 1st Platform**

SHIP MECHANICAL &
ELECTRICAL INSTALLATIONS,
MUST KEEP CLEAR

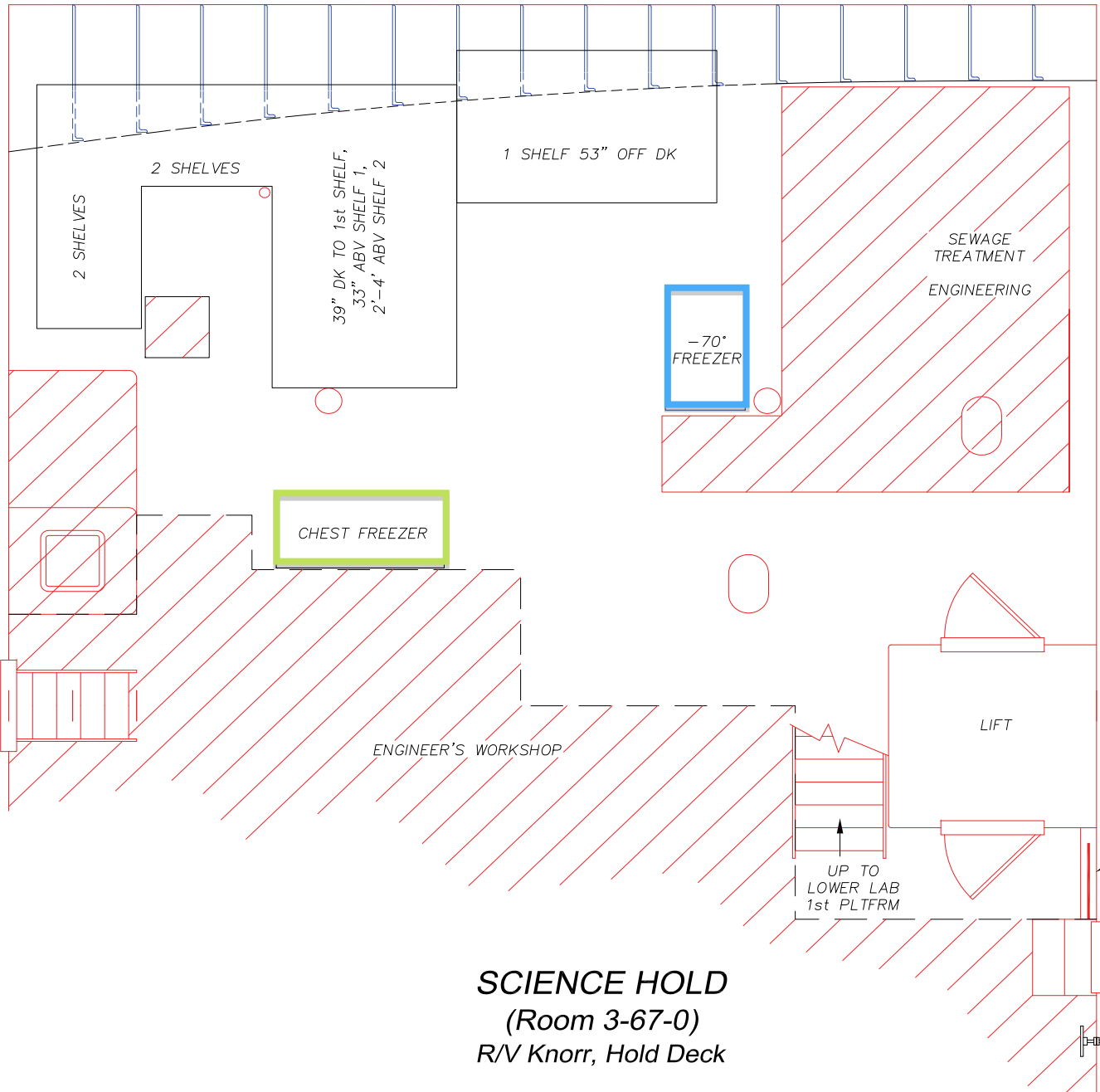

SCIENCE HOLD
(Room 3-67-0)
R/V Knorr, Hold Deck